

GL-GH - Common Replacement Part List



Item	Description	Part Number
1	Motor Options	
	PSC 115/1/60 1/28 HP	E205109
	PSC 230/1/60 1/28 HP	E201949
	EC 115/1/60 1/15 HP	E317009
	EC 230/1/60 1/15 HP	E317010
2	Motor Mount Options	
	22"	E104108
	44"	E104109
	66"	E104110
3	Fan Blade Options	
	GH	11265
	GL	11263
4	Fan Guard Options	
	PLASTIC	E316655
	WIRE (NOT INTERCHANGEABLE W/PLASTIC)	E103789
5	Air Filter	
	USED FOR WIRE GUARDS ONLY	E103798
6	Fan/Top Panel Options	
	1 FAN	E103757
	2 FAN	E103758
	3 FAN	E103759
	4 FAN	E103760
	5 FAN	E103761
	6 FAN	E103762
7	End Cover Panel (Header End)	
	GH	E103796
	GL	E103770
8	End Cover Panel (Return End)	
	GH	E103797
	GL	E103771
9	Left Cover Panel (Return End)	
	GH	E103794
	GL	E103768
10	Left Cover Panel (Header End)	
	GH	E103792
	GL	E103766
11	Right Bottom Corner Panel (Return End)	
	GH	E103795
	GL	E103769
12	Right Corner Panel (Header End)	
	GH	E103793
	GL	E103767
13	Hanger GL/GH Units Options	
	HANGER GL/GH UNITS	66022
14	Drain Pan w/ Plastic Fan Guard Options	
	1 FAN-INSULATED	CE107389H
	2 FAN-INSULATED	CE107390H
	3 FAN-INSULATED	CE107391H
	4 FAN-INSULATED	CE107392H
	5 FAN-INSULATED	CE107393H
	6 FAN-INSULATED	CE107394H
	1 FAN-NON INSULATED	CE203106
	2 FAN-NON INSULATED	CE203107
	3 FAN-NON INSULATED	CE203108

Item	Description	Part Number
14	Drain Pan w/ Plastic Fan Guard Options Cont.	
	4 FAN-NON INSULATED	CE203109
	5 FAN-NON INSULATED	CE203110
	6 FAN-NON INSULATED	CE203111
15	Drain Pan w/ Plastic Fan Guard & Heater	
	Defrost Options: H-3 PIPE HOT GAS WITH ELECTRIC DP	
	P-2 PIPE HOT GAS WITH ELECTRIC DP	
	1 FAN-INSULATED WITH HEATER	CE107389H
	2 FAN-INSULATED WITH HEATER	CE107390H
	3 FAN-INSULATED WITH HEATER	CE107391H
	4 FAN-INSULATED WITH HEATER	CE107392H
	5 FAN-INSULATED WITH HEATER	CE107393H
	6 FAN-INSULATED WITH HEATER	CE107394H
	1 FAN-NON INSULATED WITH HEATER	CE203106
	2 FAN-NON INSULATED WITH HEATER	CE203107
	3 FAN-NON INSULATED WITH HEATER	CE203108
	4 FAN-NON INSULATED WITH HEATER	CE203109
	5 FAN-NON INSULATED WITH HEATER	CE203110
	6 FAN-NON INSULATED WITH HEATER	CE203111
16	Drain Pan w/ Wire Fan Guard (Required w/ Air Filter)	
	1 FAN-INSULATED	CE202778
	2 FAN-INSULATED	CE202779
	3 FAN-INSULATED	CE202780
	4 FAN-INSULATED	CE202781
	5 FAN-INSULATED	CE202782
	6 FAN-INSULATED	CE202783
	1 FAN-NON INSULATED	CE103782
	2 FAN-NON INSULATED	CE103783
	3 FAN-NON INSULATED	CE103784
	4 FAN-NON INSULATED	CE103785
	5 FAN-NON INSULATED	CE103786
	6 FAN-NON INSULATED	CE103787
17	Wiring Harness Options	
	1 FAN 115-230V	E206449
	2 FAN 115-230V	E206450
	3 FAN 115-230V	E206451
	4 FAN 115-230V	E206452
	5 FAN 115-230V	E206453
	6 FAN 115-230V	E206454
	1 FAN 460V	E206518
	2 FAN 460V	E206519
	3 FAN 460V	E206520
	4 FAN 460V	E206521
	5 FAN 460V	E206522
	6 FAN 460V	E206523
18	Thermostat Options	
	DEFROST TERMINATION FIXED (KLIXON)	E206100
	HEATER SAFETY THERMOSTAT	10956
	HEATER SAFETY THERMOSTAT SPDT	E206465
	FAN DELAY	E201818
	KP-73	E205004

GL-GH - Common Replacement Part List

19	Pan Heater Options	
	115/230/1/60, 1 FAN	63108
	115/230/1/60, 2 FAN	63109
	115/230/1/60, 3 FAN	63110
	115/230/1/60, 4 FAN	63111
	115/230/1/60, 5 FAN	63112
	115/230/1/60, 6 FAN	63113
20	Coil Heater Options	
	230V, 1 FAN	E101930
	460V, 1 FAN	E101936
	230V, 2 FAN	E101931
	460V, 2 FAN	E101937
	230V, 3 FAN	E101932
	460V, 3 FAN	E101938
	230V, 4 FAN	E101933
	460V, 4 FAN	E101939
	230V, 5 FAN	E101934
	460V, 5 FAN	E101940
	230V, 6 FAN	E101935
	460V, 6 FAN	E101941
21	Face Heater Clip	
	FACE HEATER CLIP	E102007
22	Bottom Heater Support	
	BOTTOM HEATER SUPPORT	E205740
23	Check Valve Options	
	CHECK VALVE	11852
	CHECK VALVE	11853

24	Expansion Valve Options	
	EBSJE-5-C	E206822
	EBSSE-6-C	E314439
	EGJE-1/2-C	E205915
	EGJE-1/4-C	E206474
	EGJE-1-1/2-C	E206131
	EGJE-1-C	E205916
	EGJE-2-C	E205987
	EGSE-1/2-C	E205984
	EGSE-1/4-C	E206277
	EGSE-1-1/2-C	E205983
	EGSE-1-C	E205982
	EGSE-2-C	E205985
	EGVE-1/2-C	E205717
	EGVE-1-1/2-C	E205723
	EGVE-1-C	E205721
	EGVE-2-C	E205781
	EGVE-3/4-C	E205719
	EGVE-3-C	E205803
	SBFJE-AA-C	E205991
	SBFJE-A-C	E205992
	SBFJE-B-C	E205993
	SBFJE-C-C	E205994
	SBFSE-AA-C	E206015
	SBFSE-A-C	E206013
	SBFSE-B-C	E206014
	SBFSE-C-C	E206016
	SBFVE-AA-C	E205501
	SBFVE-A-C	E311117
	SBFVE-B-C	E205500
	SBFVE-C-C	E311118

REVISIONS				
CHANGE ORDER	REV	DESCRIPTION	DATE	APPROVED

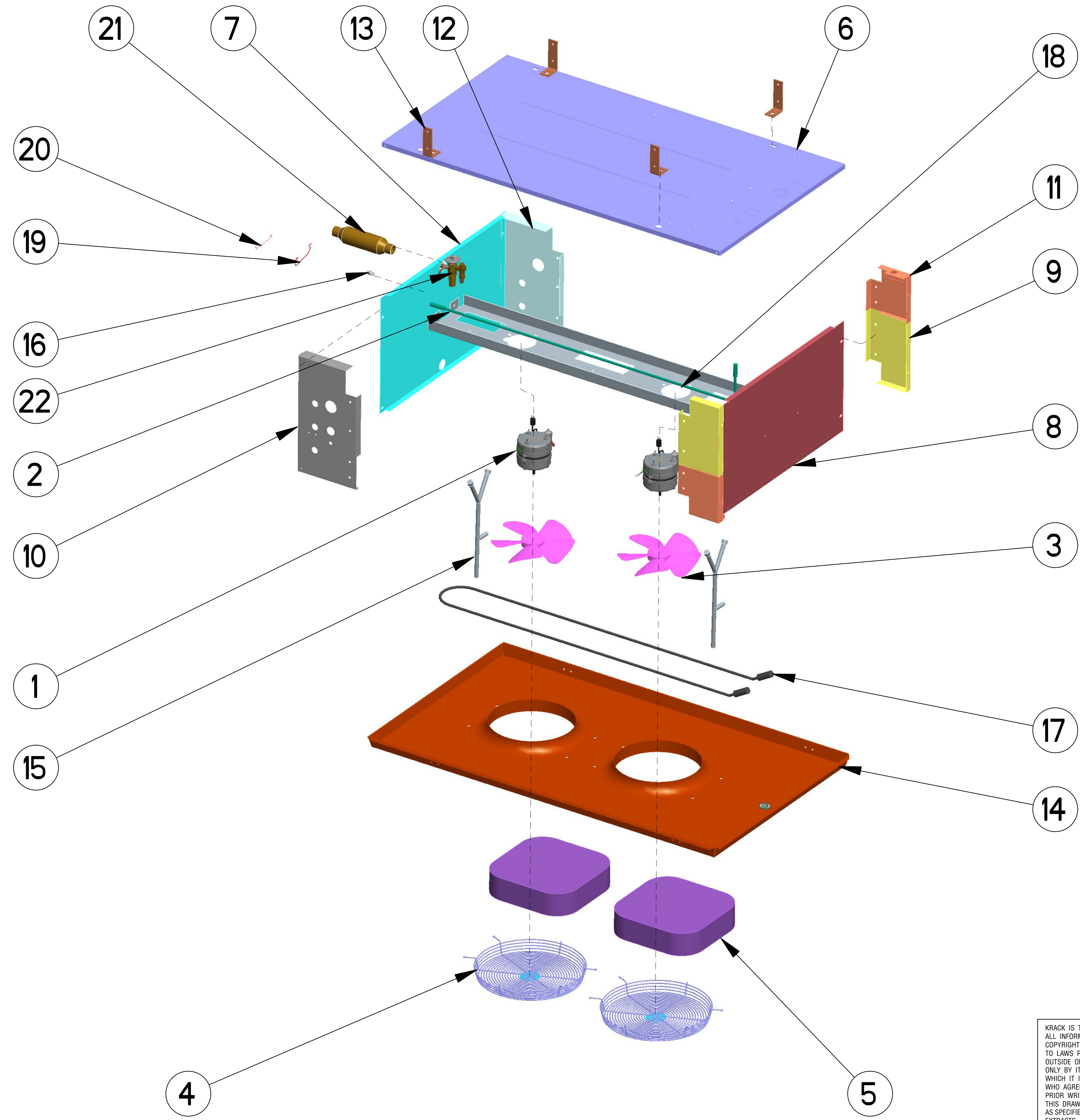

ITEM NO	DESCRIPTION
22	EXPANSION VALVE
21	CHECK VALVE
20	BOTTOM HEATER SUPPORT
19	FACE HEATER CLIP
18	COIL HEATERS
17	PAN HEATERS
16	THERMOSTATS
15	WIRING HARNESS
14	DRAIN PAN WITH FAN GUARD
13	HANGER GL/GH UNITS
12	RIGHT CORNER PNL (HEADER END)
11	RIGHT BOT CNR PANEL (RETURN END)
10	LEFT CORNER PNL (HEADER END)
9	LEFT CORNER PANEL (RETURN END)
8	END COVER PANEL (RETURN END)
7	END COVER PANEL (HEADER END)
6	FAN/TOP PANEL
5	AIR FILTER
4	FAN GUARD
3	FAN BLADE
2	MOTOR MOUNT
1	MOTOR

LIST OF MATERIALS	
KRACK	
TITLE GL_GH COOLER UNIT	
SIZE D	DWG NO E109402
SCALE 0.150	SHEET 1 OF 1

KRACK IS THE SOLE OWNER OF THIS DRAWING AND ALL INFORMATION IN IT, WHICH ARE PROTECTED BY COPYRIGHT AND OTHER LAWS AND MAY BE SUBJECT TO LAWS REGARDING EXPORTING INFORMATION OUTSIDE OF THE U.S. THIS DRAWING MAY BE USED ONLY BY ITS RECIPIENTS FOR THE PURPOSE FOR WHICH IT IS PROVIDED AND ONLY BY THE RECIPIENT, WHO AGREES THAT IT WILL NOT, WITHOUT KRACK'S PRIOR WRITTEN PERMISSION: 1) DISCLOSE NOR USE THIS DRAWING OR THE INFORMATION IN IT EXCEPT AS SPECIFIED ABOVE; OR 2) MAKE ANY COPIES OF OR EXTRACTS, REVISIONS, OR UPDATES FROM THE DRAWING. ALL COPIES MUST BE RETURNED TO KRACK UPON COMPLETION OF THE WORK FOR WHICH THEY HAVE BEEN PROVIDED OR UPON ANY EARLIER REQUEST.

UNLESS OTHERWISE SPECIFIED DIMENSIONS ARE IN INCHES. INTERPRET DIM AND TOL PER ASME Y14.5M - 1994		CAD GENERATED DRAWING. DO NOT MANUALLY UPDATE.	
THIRD ANGLE PROJECTION	DRAWN RKS	DATE 17-Sep-09	TITLE GL_GH COOLER UNIT
	CHECKED -		
	APPROVED -		
FINISH -	ENG APPVL -		